

TRIUMPH

M O D U L A R

A T E C N O F A S T C O M P A N Y[®]

QUALITY SOLUTIONS



MOBILE OFFICE FLEET



TEMPORARY SOLUTIONS



Rental Division

Triumph Modular has a 40-year history of experience leasing and providing space solutions across a variety of industries.

What are the features of the mobile offices?

Our fleet features a sleek grey color scheme with a wood exterior siding. Our interiors have all been standardized to include motion sensor light switches, USB ports, and energy-efficient windows.

Which States do we service and deliver to?

Triumph Modular's Boston Headquarters services Massachusetts, New Hampshire, Connecticut, and Rhode Island. Our Northern New England branch services Maine, Vermont, and New Hampshire. The Pittsburgh Region branch services western Pennsylvania, Ohio, and West Virginia. The Philadelphia Region branch services eastern Pennsylvania, New Jersey, and Delaware.

What are the different mobile office options?

We offer small office trailers (8' wide), medium office trailers (10' wide), and large office trailers (12' wide). We also offer 20' and 40' ground-level office containers* (New England area only). For larger jobs, we offer double-wide modular buildings (24' wide) and complexes that can be built to suit any desired office space.

What are the benefits of a mobile office?

Mobile offices are great for temporary office space. These mobile offices can be delivered and set up for short-term and long-term usage. We can add steps, ramps, and a variety of office furniture solutions to create a comfortable and convenient experience. If ground-level access is needed, an office container offers a very secure solution at any job site.

COMPARE MOBILE OFFICE OPTIONS

Width & Length	Office Square Feet	Private Offices	Bathroom	Heating/Cooling
8' x 24' OFFICE TRAILER	192	NONE	NONE	10,000 BTU Thru Wall
8' x 32' OFFICE TRAILER	224	1 PRIVATE OFFICE	OPTIONAL	1-Ton Wall-Mounted Bard
10' x 36' OFFICE TRAILER	320	1 PRIVATE OFFICE	OPTIONAL	1-Ton Wall-Mounted Bard
10' x 44' OFFICE TRAILER	400	1 PRIVATE OFFICE	YES	2-Ton Wall-Mounted Bard
10' x 50' OFFICE TRAILER	460	2 PRIVATE OFFICES	OPTIONAL	2-Ton Wall-Mounted Bard
12' x 60' OFFICE TRAILER	672	2 PRIVATE OFFICES	OPTIONAL	3-Ton Wall-Mounted Bard
12' x 64' OFFICE TRAILER	720	2 PRIVATE OFFICES	YES	3-Ton Wall-Mounted Bard
8' x 20' CONTAINER OFFICE	160	NONE	NONE	8,000 BTU Thru Wall
8' x 40' CONTAINER OFFICE	320	NONE	NONE	8,000 BTU Thru Wall
8' x 40' COMBO OFFICE & STORAGE	128	NONE	NONE	8,000 BTU Thru Wall

MOBILE OFFICES



THE SOLUTIONS

Triumph Modular's furniture and accessory solutions can provide additional immediate move-in capability to your mobile office. Our focus is to help our customers get their offices functioning quickly and conveniently so you can spend more time focusing on the job at hand.

Express Bistro Solution



Express Workstation Solution



Business Office Solution



Business Breakroom Solution



Business Conference Solution



Express Office Solution



THE SOLUTIONS



BLOCSTM

Triumph Modular's BLOCSTM system takes your project from concept to completion, with a limitless open concept.

Two restrooms
and storage closet

No columns or supporting
walls are required.

Less bounce in the
building due to the use
of a perimeter frame.

Fast and flexible to
accommodate all sizes
and configurations

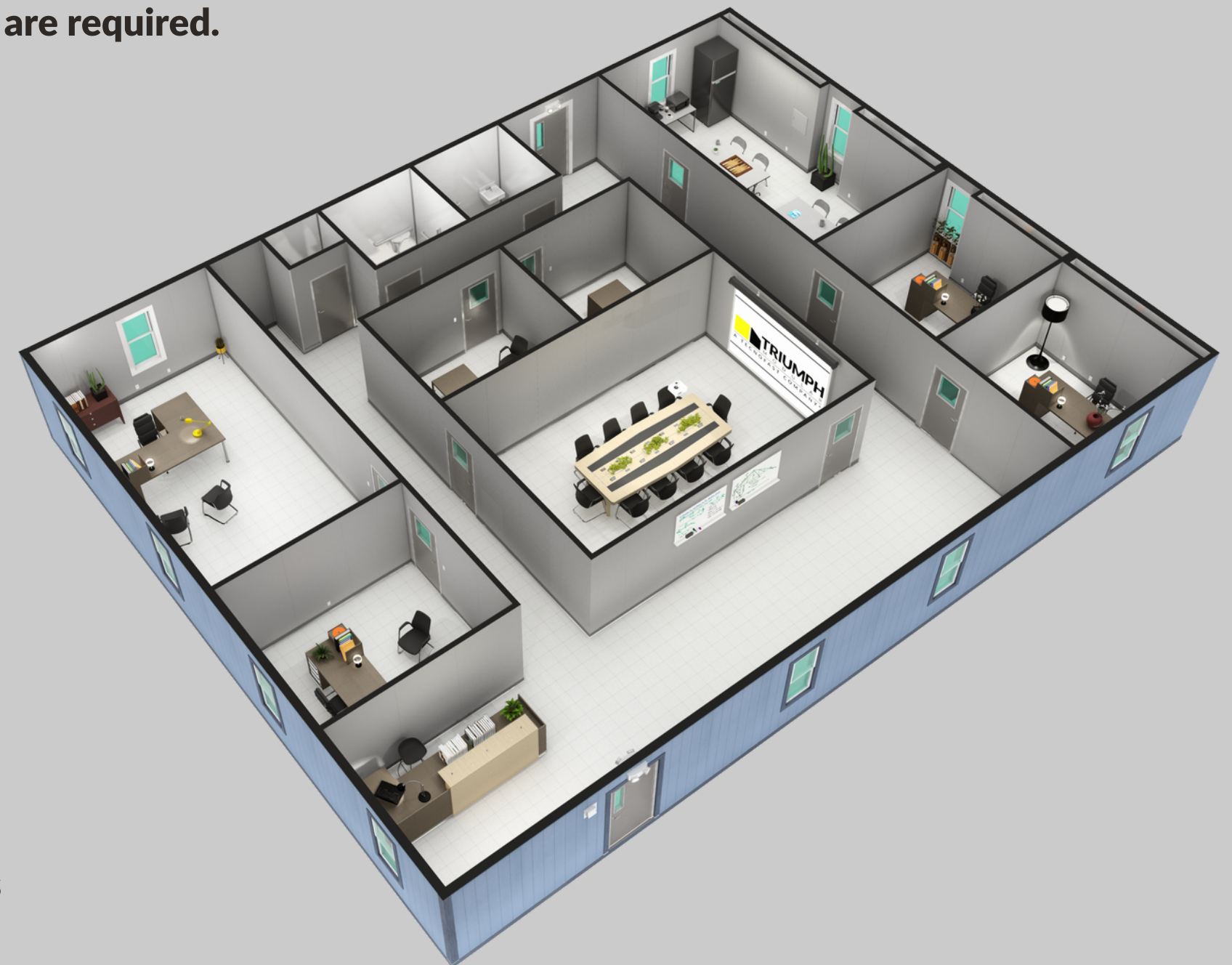
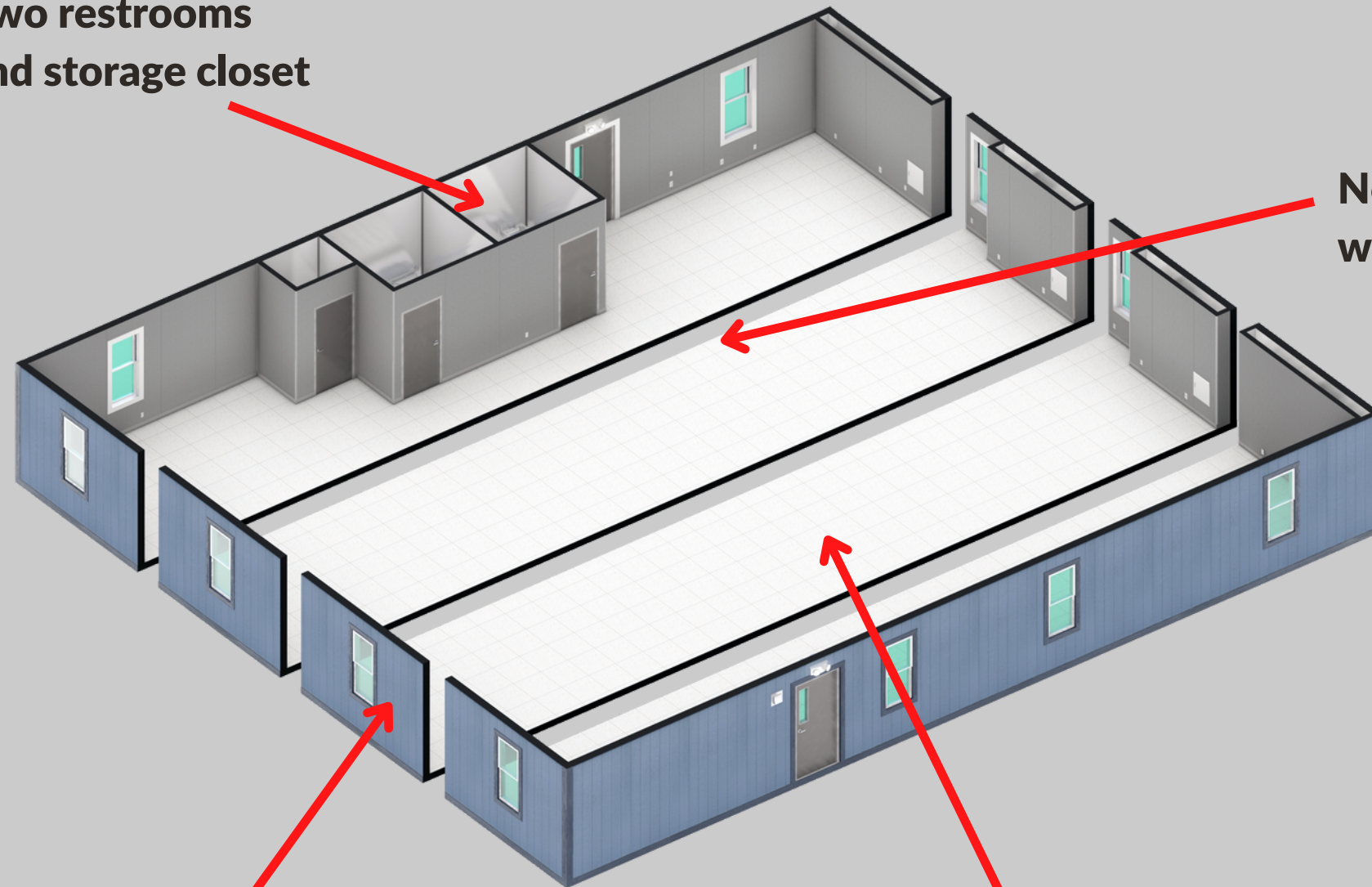

BLOCSTM Walls



Features and Benefits



**8-foot-tall Modular
Walls**



**Installed using a track
system**

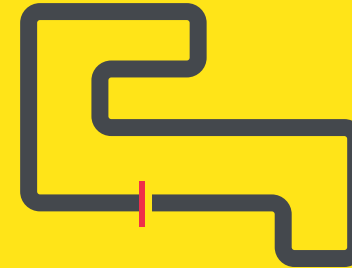

**Flexible configurations
to assist with desired
layouts**

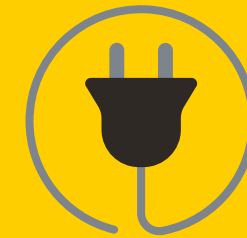

**Electrical raceways
between wall panels**



Contact Us

QUESTIONS?

1-800-257-2536

www.TriumphModular.com

INNOVATION



QUALITY



EXPERIENCE